



Fitment of a 3, 8 or 18 litre pressure vessel is encouraged to reduce pump starts and save energy.

Whenever the controller is operated in Mode 2 (Pressure switch) fitment of a pressure vessel is mandatory

PRODUCT DETAILS

The DAB JINOX62PRO pairs the stainless steel, self-priming DAB62M centrifugal pressure pump with the highly versatile BIANCO NXT PRO dual mode pump controller. The NXT PRO offers unparalleled pump control and protection. This pressure system is particularly suited to water supply in domestic installations, small-scale agriculture, gardening and wherever self-priming operation is required.

DAB Jinox pumps are renowned for their unique self priming and extraordinary deep suction capability; up to 8 metres at sea level.

APPLICATIONS

- Household water supply - small dwellings
- Light garden irrigation
- Water transfer
- Washing systems
- Pressure boosting

PUMP FEATURES

- Motor support in cast iron, technopolymer impeller, diffuser, Venturi tube and sand guard. Stainless steel adjustment rings and pump body.
- Carbon/ceramic mechanical seal.
- Asynchronous motor closed and cooled by external ventilation. Max Ambient temp 40 deg C
- Built-in thermal and current overload protection and a capacitor permanently on in the single-phase versions.

TECHNICAL DATA

OUTPUT POWER (KW)	0.44kW P2
MAX. HEAD [M]	42M
MAX. FLOW L/MIN	45 l/min
MAX PRESSURE - PUMP	8 bar
MAX PRESSURE - CONTROL	10 bar
LIQUID TEMPERATURE	2 - 35 deg C
MOTOR	Asynchronous TEFC
MOTOR INSULATION	F Class insulation
MOTOR PROTECTION	In-built thermal overload
PROTECTION CLASS	IP44. Terminal board I.P.55

RATED VOLTAGE	220 - 240V 1Ph 50 Hz
RATED CURRENT	3.12A
CAPACITOR	10uF 450V
POWER CABLE	1.5m long 10 amp rated H05 flex 10 amp 3 pin plug
PUMP BODY	AISI 304 X5 Cr Ni 1810 UNI 6900/71
INTERNALS	Technopolymer A
MECHANICAL SEAL	Carbon/Ceramic
AUTOMATIC OPERATION	Yes: BIANCO NXT PRO
PACKAGE DIMENSION	L470 x W240 x H240mm
GROSS WEIGHT (KG)	7.8kg pump, 2.1kg controller

PRODUCT DETAILS



BiANCO NXT PRO is a single pump, dual mode, digital, electronic pump controller.

The PRO controller has a number of optional advanced features but out of the box, the NXT PRO is simple to use.

Mode 1. (Default) Pressure controller

Starts as pressure falls to a user adjustable level.

Stops when flow falls to less than 1 l/min.

Mode 2. Pressure switch (requires pressure tank)

Starts and stops according to user adjustable settings

With full push-button programming, NXT PRO has a digital display to provide information about the running state of the pump

APPLICATIONS

- Control of pressure pumps up to 2.2kW (16 amp)
- Suitable for clean, non-volatile liquids without fibres or solids including potable water

ADVANCED FEATURES

- Swivel unions - 1" or 1 1/4" BSPM
- Pump Protections: Dry run, Low flow, Frequent start, Underload, Overload, Over pressure, Anti-seize, Maximum continuous run time
- No reactive metal parts in contact with the water
- Generator compatible
- Removable pressure accumulator exposes 1" BSPF port

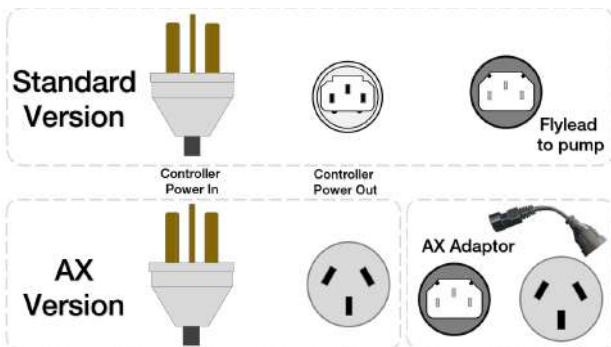

CONTROLLER TECHNICAL DATA

INPUT VOLTAGE	80 - 260 AC 1 Phase
MAX. WORKING TEMP	35 deg C
MAX TEMP	60 deg C
MAX RATED PRESSURE	10 bar
MAX RATED FLOW	1" Port: 150 l/m @ 0.8 bar loss 1 1/4" Port: >350 l/m @ 0.8 bar loss
INLET/OUTLET	1" BSPM / 1" BSPM (std)
NET WEIGHT	2.1kg

MAXIMUM CURRENT	16 Amps
NOMINAL PUMP POWER	2.2 kW
INGRESS PROTECTION	IP65
AUTOMATIC	Yes, with dry run protection
DEFAULT START PRESSURE	2.2 bar - adjustable
POWER CABLE	1.5m H05, 10 amp plug Controller to pump - options.
PACKAGING DIMENSIONS	220 x 230 x 200

CONTROLLER CURVE

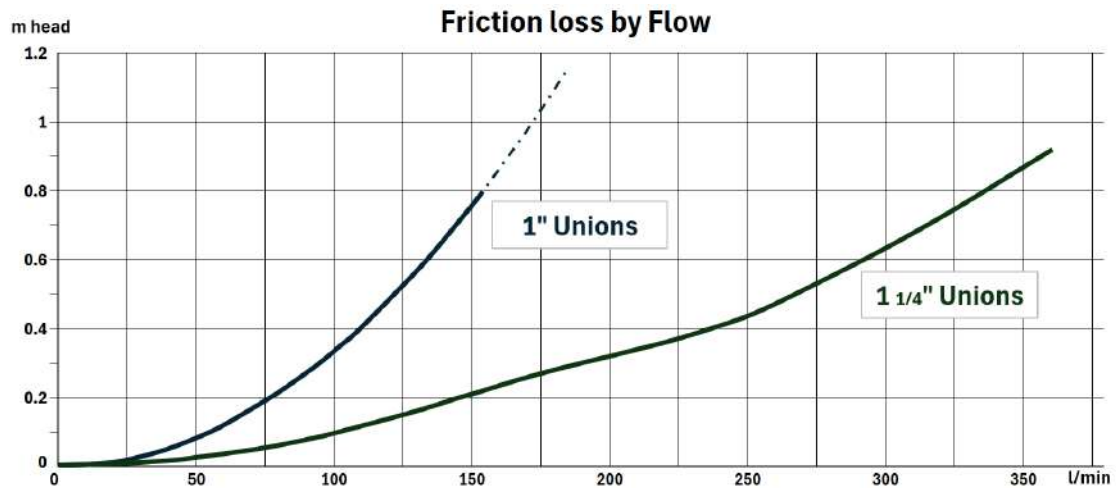

DIMENSIONS

DIMENSIONS	
H 1	212mm
H 2	115mm
W 1	175mm
W 2	152mm
W 3	57mm
L 1	261mm
L 2	93mm
L 3	168mm
L 4	(121mm)

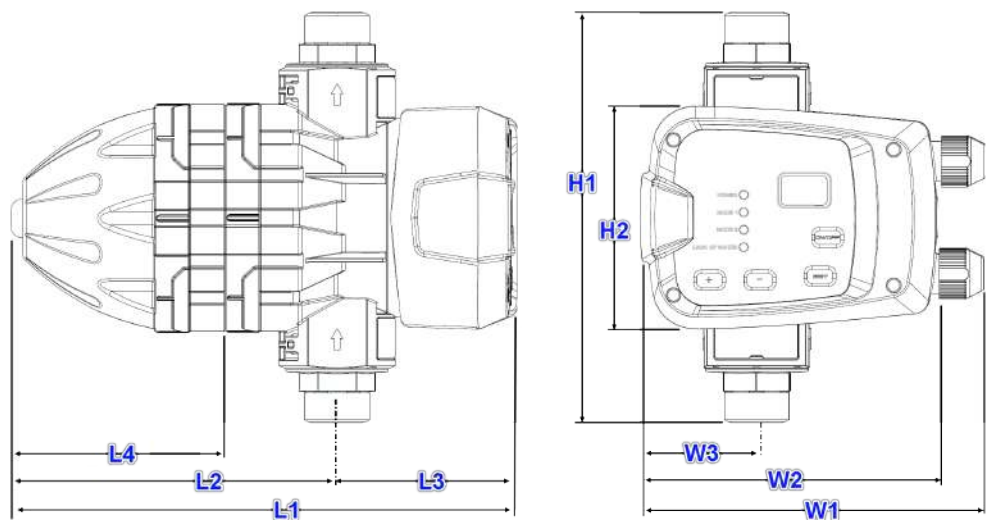

WARRANTY / CERTIFICATIONS



PUMP CURVE

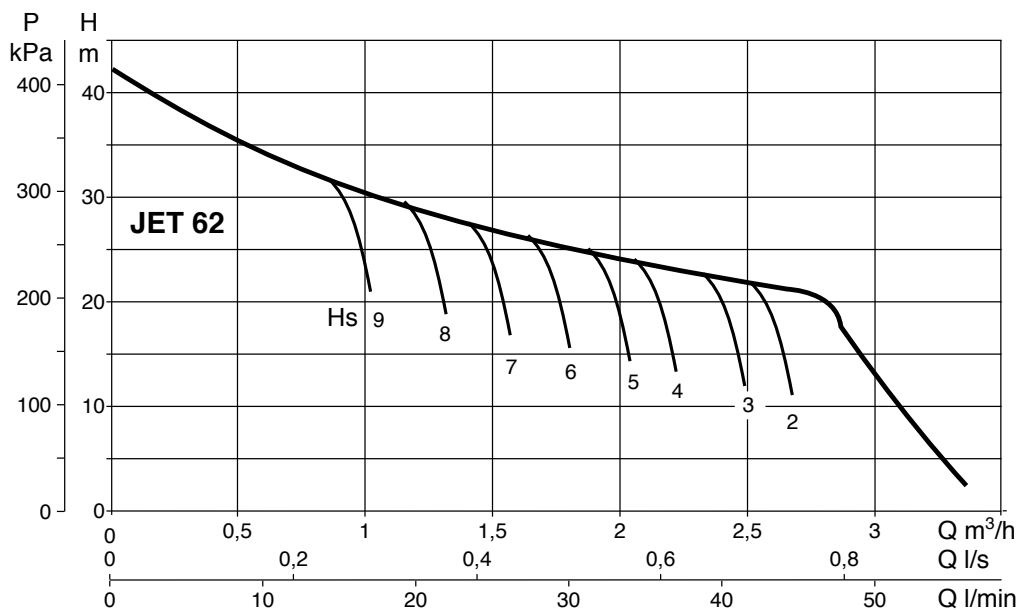

PUMP DIMENSIONS

A	406
B	174
C	122
E	207
F	14
G	111
H	197
H2	144
I	Dia 9
DNA	1" GAS
DNM	1" GAS

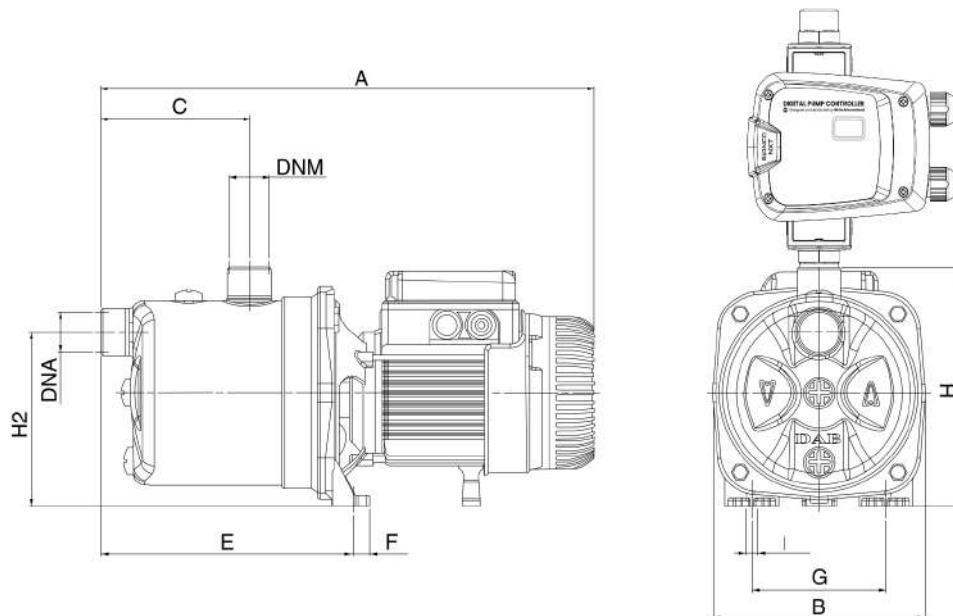

Height with controller fitted
H2 + approx 246mm = 390mm

WARRANTY / CERTIFICATIONS

